

Advisor Pack



Balloons and more!
Easy to order at
balloons.com

Introducing **ColorCloud™** & **ColorColumn™**

4'
TALL

Add sparkle to any
school event!

- Easy Assembly
- Lasts for Weeks
- Variety of Colors
- No Helium Required
- Everything's Included!



**4' Red & Silver
ColorCloud™**
#49533
24.95 ea



**8' Red & Silver
ColorColumn™**
#49543
34.95 ea



**Mini Cool
Aire Inflator**
#1993
169.39 ea

Great for:
Pep Rallies
Sporting Events
Homecoming
Prom

8'
TALL

ColorCloud™ & ColorColumn™



**4' Blue & Silver
ColorCloud™**
#49534
24.95 ea



**4' Gold & Silver
ColorCloud™**
#49535
24.95 ea



**4' Christmas
ColorCloud™**
#49532
24.95 ea



**4' Black & Silver
ColorCloud™**
#49537
24.95 ea



**4' Purple & Silver
ColorCloud™**
#49536
24.95 ea



**4' Green & Silver
ColorCloud™**
#49538
24.95 ea



Free hand pump with every kit!



**8' Blue & Silver
ColorColumn™**
#49544
34.95 ea



**8' Gold & Silver
ColorColumn™**
#49545
34.95 ea



**8' Christmas
ColorColumn™**
#49542
34.95 ea



**8' Black & Silver
ColorColumn™**
#49547
34.95 ea



**8' Purple & Silver
ColorColumn™**
#49546
34.95 ea



**8' Green & Silver
ColorColumn™**
#49548
34.95 ea

MASCOTS

Order 5 per style.



23" Falcon or Hawk Mascot A
PKG #96716
 2.99 ea
 Small Shape



23" Eagle Mascot A
PKG #96722
 2.99 ea
 Small Shape



27" Roaring Bear Mascot A
PKG #96733
 2.99 ea
 Small Shape



25" Roaring Lion Mascot A
PKG #96734
 2.99 ea
 Small Shape



24" Huskie Mascot A
PKG #96750
 2.99 ea
 Small Shape



28" Knight Mascot A
PKG #96712
 2.99 ea
 Small Shape



24" Panther Mascot A
PKG #96703
 2.99 ea
 Small Shape



24" Ram Mascot A
PKG #96705
 2.99 ea
 Small Shape



21" Bulldog Mascot A
PKG #96728
 2.99 ea
 Small Shape



24" Fighting Tiger Mascot A
PKG #96761
 2.99 ea
 Small Shape



24" Bobcat or Wildcat Mascot A
PKG #96702
 2.99 ea
 Small Shape

Λ Balloons float up to 7,200 feet
 Δ Balloons float up to 6,000 feet

Balloon Basics

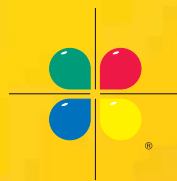

BALLOONS
EVERYWHERE

balloons.com • 800-239-2000

Balloon Basics

Table of Contents:

Foil Inflation	3
Latex Inflation	4
California Balloon Law	5
String of Pearls Arch	6
Latex Arch	7 - 8
Column Using Arch Line	9 - 10
MagicArch™	11
Foil Arch and Column Kit.	12 - 13
Latex Arch and Column Kit.	14 - 15

Foil Inflation:

- 1) Insert the nozzle of a foil helium regulator, air inflator, or hand pump into the hole on the tail of the balloon. Note: Do NOT use a latex regulator for foil balloons. Doing so will damage the valve of your balloon.
- 2) Fill the balloon until it is firm with uniform creases along the seams. Note: If you are using an automatic helium regulator, the inflator will automatically shut off the flow of helium when the balloon has reached the correct size and pressure.
- 3) Standard balloons and foil shapes have self-sealing valves. Just pull the balloon off the inflator tip.

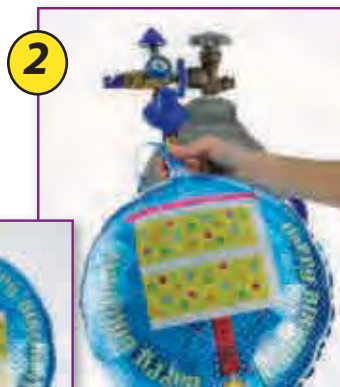

Tip:

Foil balloons can be "topped off" when they are no longer firm.

Ribbon Tying Method:

- 1) Tie ribbon below the valve of the foil balloon. Tying the ribbon above the valve damages the valve.

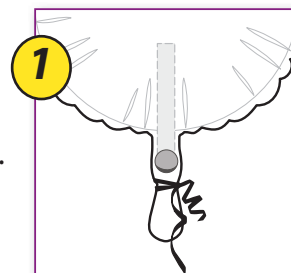

Latex Inflation:

- 1) Insert the nozzle of a latex helium regulator, air inflator, or hand pump into the neck of the balloon.
- 2) Fill the balloon until a teardrop shape is achieved.
- 3) Pinch the balloon above the inflator, and remove the nozzle. Tie the balloon to seal it.



Tip:

Use Hi-Float™ to extend the float time of latex balloons.

Ribbon Tying Method:

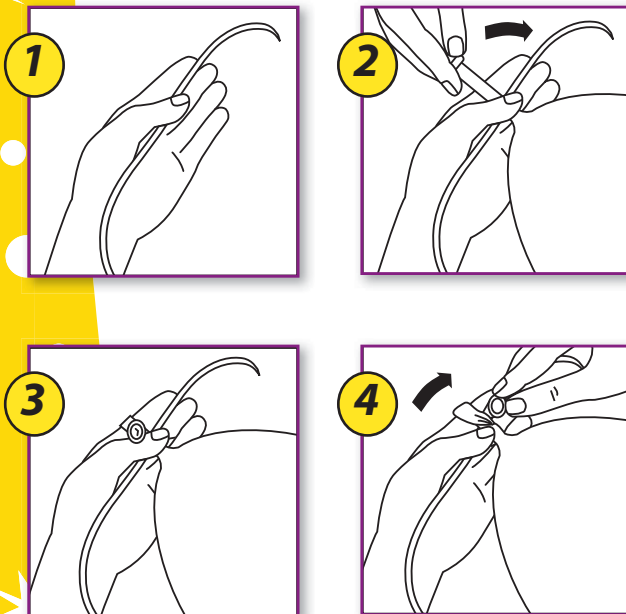

- 1) In your left hand, lay ribbon across your palm, allowing enough ribbon for a tail to extend from your fingertips.
- 2) Place neck of an inflated balloon across the ribbon (neck pointing up) and hold both securely with your thumb.
- 3) With your right hand, stretch the neck around the index and middle fingers of your left hand and then back around to the front.
- 4) Use your thumb and forefinger to tuck in the neck, making sure to grab the ribbon while making the knot. Remove fingers from the knot.
- 5) Curl ribbon tail.

NOTE: For left handed persons use opposite hands.
To protect your fingers from irritation, tie close to your fingertips.

Bring **LAW & ORDER** to your balloon décor!



Follow the California Balloon Law:

- Weight all helium-filled foil balloons.
- Tie all ribbons to the weight so if they are released they will float away individually.
- DO NOT** tie ribbons together before attaching to weight. Tie them to the weight with one knot.
- Do not use metallic ribbon with helium-filled balloons.

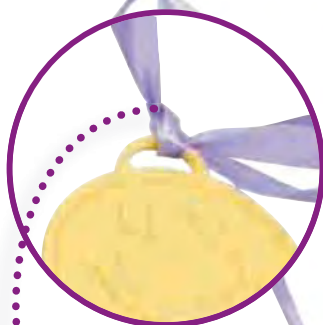

Example
of properly
weighted bouquet.



String of Pearls Arch

Ingredients

11" latex balloons
50 lb. monofilament (fishing) line
Helium
ProSizer™ template (11-inch size)
Weights
Scissors

Use Air!
instead of helium
and hang as
garland!

Instructions

- 1) Cut a piece of monofilament line to desired length and secure both ends to stationary objects, such as doorknobs or chairs. Make sure the line is tight.
- 2) Helium inflate one of the balloons, sizing it to the desired size with the balloon template.
- 3) Tie the neck of the balloon around the monofilament line. (Tying the balloon around the line allows you to adjust its position, if necessary, by wetting the line and gently sliding the balloon to the desired spot.)
- 4) Inflate the next balloon and tie onto the line so it gently rests against the balloon beside it. Repeat until all balloons are added.

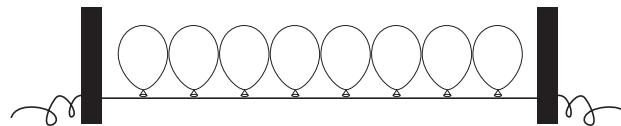

- 5) Remove the line from the stationary objects and anchor by tying each end around a weight.

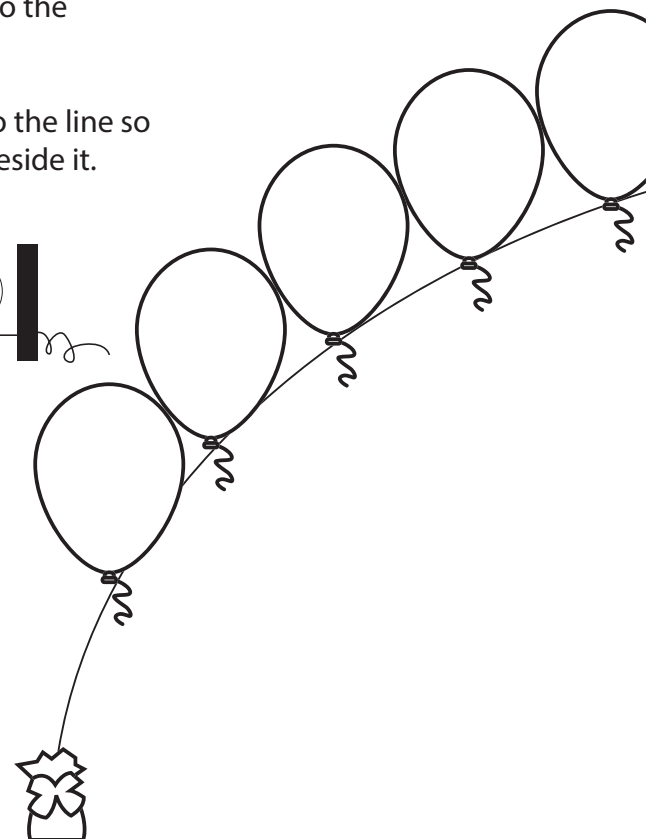

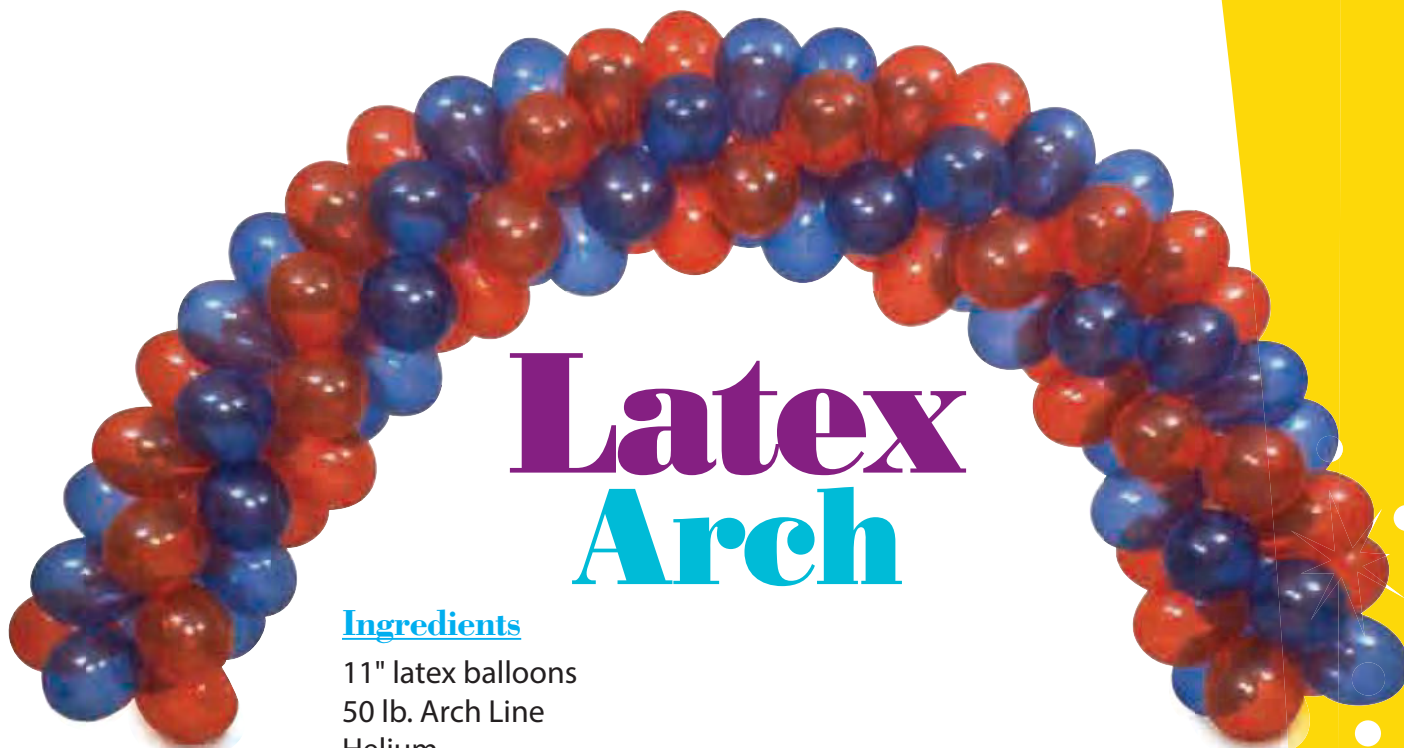

Latex Arch

Ingredients

11" latex balloons
50 lb. Arch Line
Helium
ProSizer™ template (11" size)
Weights

Instructions

- 1) Calculate the line length for your arch.

Latex Arch Calculator*			
Taller than Wide:			
$(2 \times \text{height})$	$+ \text{width}$	$+ 6 \text{ ft}$	$= \text{total length}$
<small>height</small>	<small>width</small>		<small>total length</small>
Wider than Tall:			
height	$+ \text{width}$	$+ 6 \text{ ft}$	$= \text{total length}$
<small>height</small>	<small>width</small>		<small>total length</small>
Same Height and Width:			
$(1.5 \times \text{height})$	$+ \text{width}$	$+ 6 \text{ ft}$	$= \text{total length}$
<small>height</small>	<small>width</small>		<small>total length</small>

- 2) Cut arch line to the length calculated in step 1. Stretch line to the full length and tie each end to sturdy anchors 3 feet from each end. Line should be pulled tight between anchors.

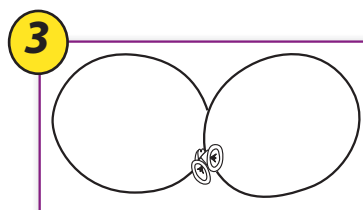

- 3) Create a duplet: Helium inflate one 11" latex balloon, and pinch the neck while inflating another 11" latex balloon. Hold the balloons with their necks crossed, and twist one balloon over the neck of the other and back to its original position. Tie the necks together.

Continued on Page 8

Instructions - continued

- 4) Repeat Step 3 to create a second duplet.
- 5) Make a cross with the two duplets, pushing the centers together. Twist two balloons together, one from each duplet. This creates a four-balloon cluster.
- 6) Attach the cluster to the arch line by slipping the arch line between two balloons of the cluster. Twist those two balloons around each other to secure the cluster to the line.
- 7) Repeat steps 3-6, closely packing each consecutive cluster. To make a spiral effect, slightly turn each cluster in the same direction.

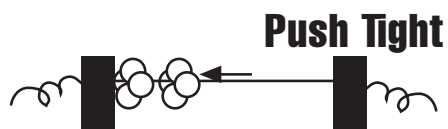
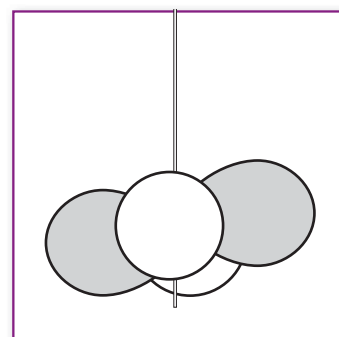
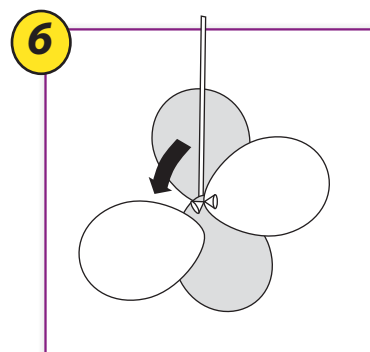
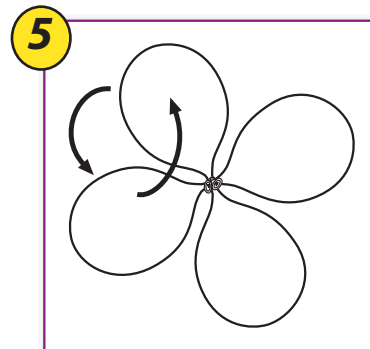

- 8) Continue to desired length. Untie line from anchors and attach to sufficient anchors for decorating (i.e., bricks, gallon bottles filled with water, etc.). Move anchors together until desired arch height is achieved.

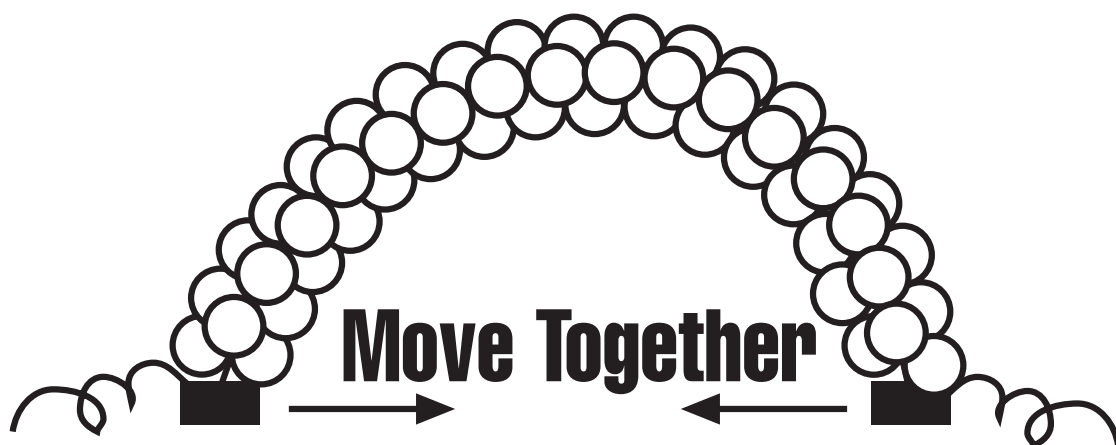

Column using Arch Line

Ingredients

- 32 11" latex balloons (8 of each color)
- Heavy weight
- Arch Line
- Professional Cool Aire® Inflator
- ProSizer™ template (10" size)
- Optional - Helium for column topper

Instructions

- 1) Determine the height of your column.
- 2) Cut a length of arch line to 1½ times the height of your column.
- 3) Tie the arch line to a heavy weight.
- 4) Create a duplet: Air inflate one balloon to 10", and pinch the neck closed while inflating another balloon of a different color to 10". Hold the balloons with their necks crossed, and twist one balloon over the neck of the other and back to its original position. Tie the necks together.
- 5) Repeat Step 4 with the the remaining two colors to make a second duplet.
- 6) Make a cross with the two duplets, pushing the centers together. Twist two balloons around each other (one from each duplet) to make a four-balloon cluster.



**No
Helium
Needed!**

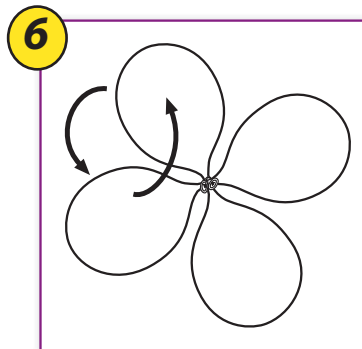
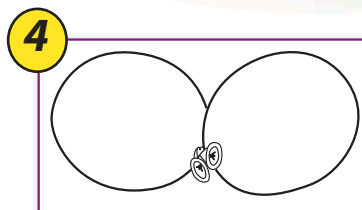

Instructions - continued

- 7) Attach the cluster to the arch line by pulling the line up through the center of the cluster, then wrapping it in a figure 8 around the center of the cluster. Push down on the balloons in the cluster so they sit flat.
- 8) Repeat Steps 4 - 7 to create enough clusters to reach your desired height.
- 9) Continue adding clusters to the arch line, rotating each cluster 45 degrees so it nests into the cluster before it. Remember to arrange balloons so that they appear to spiral.
- 10) For added impact, your column can be topped with a helium-filled 3' balloon, jumbo round or star foil balloon, Bubble™ or Orbz™.

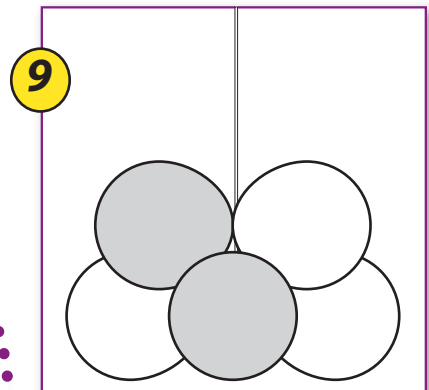
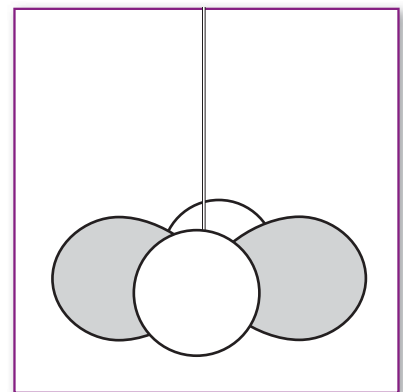
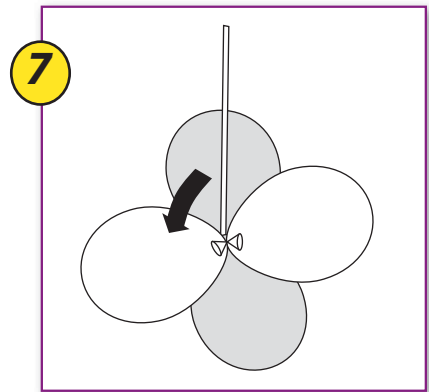

Tip:

When working in limited space or high traffic areas, tie one end of arch line to a balloon weight and place the spool in your pocket. Ease out the line as needed when attaching balloons.



MagicArch™

Ingredients

MagicArch™ balloons (use MagicArch™ calculator* below to determine quantity needed)

Arch Line

(do not use Monofilament)

Brick or Base Plate

Mini Cool Aire Inflator (for air-filled only)

3/4" Conduit (for air-filled only)

1/8" Aluminum Rod (for air-filled only)

Instructions

- 1) Cut arch line to desired arch length plus two extra feet.
- 2) Attach one end of arch line to a heavy weight (brick, water weight, etc.)
- 3) Helium inflate first Magic Arch™ unit.
- 4) Thread arch line through the center of the MagicArch™.
- 5) Repeat steps 3 - 4 until all MagicArch™ units are attached.
(Turn each 90° for a snug fit).
- 6) Secure arch line to a second heavy weight (brick, water weight, etc.)

Note: For an air-filled MagicArch™ column, use the Foil and Arch Column Kit (#721124)

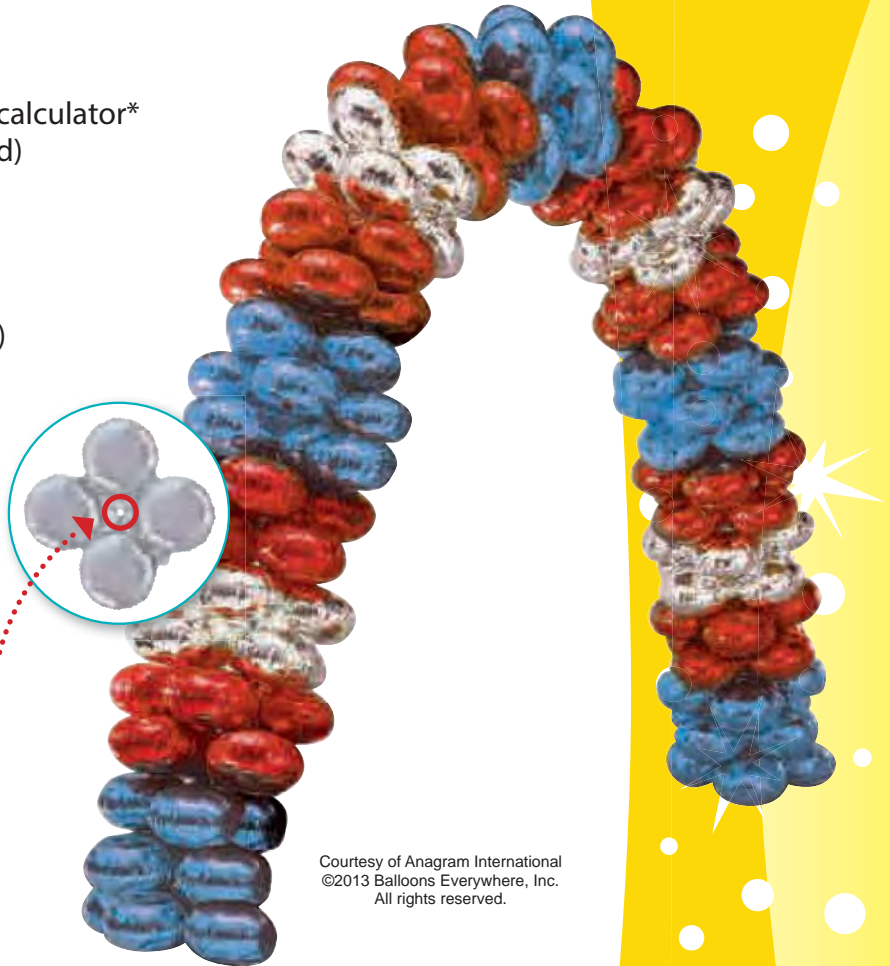

Courtesy of Anagram International
©2013 Balloons Everywhere, Inc.
All rights reserved.

MagicArch™ Calculator*

Taller than Wide:

$$(2 \times \frac{\text{height}}{\text{in}}) + \frac{\text{width}}{\text{in}} = \frac{\text{total length}}{\text{in}} \div 7.8 = \frac{\text{units needed}}$$

Wider than Tall:

$$\frac{\text{height}}{\text{in}} + \frac{\text{width}}{\text{in}} = \frac{\text{total length}}{\text{in}} \div 7.8 = \frac{\text{units needed}}$$

Same Height and Width:

$$(1.5 \times \frac{\text{height}}{\text{in}}) + \frac{\text{width}}{\text{in}} = \frac{\text{total length}}{\text{in}} \div 7.8 = \frac{\text{units needed}}$$

Arch & Column Kit Instructions

Foil Kit - #721124

Foil Arch and Column Kit includes:

- 4 Fillable Bases
- 2 Interlocking extension poles (4 pieces)
- 1 - 20 ft. expandable arch frame
- 1 Electric foil balloon inflator
- 1 Set Balloon Column Topper Caps

Additional items needed:

- 58 MagicArch™ modules
- 2 Jumbo column topper balloons

**No
Helium
Needed!**



Base Assembly Instructions:

- 1) Remove the pole receptacle bottom of each base.
- 2) Place the bases where you intend to display your columns.
- 3) Fill the bases with sand, kitty litter or marbles for stability. (Filling the bases with water is NOT recommended.) Note: Be careful not to drop the bases when weighted. Dropping or slamming bases when full may lead to cracking and breakage of the base.
- 4) Insert the pole receptacle into the center of each base, align and turn to lock.

Column Instructions:

- 1) Air inflate 10 MagicArch™ modules.
- 2) Connect pole pieces to make 2 large extension poles. Make sure the button on one pole aligns with the hole of the other pole half and locks.
- 3) Insert the 62" pole into the pole receptacle cup in the base and turn the top of the pole receptacle to tighten around the pole for a secure fit.
- 4) One by one, slide the center hole of each MagicArch™ balloon over the pole. Use alternate colors if desired.
- 5) Once the balloons are stacked on the pole, press down on the top balloons to expose enough of the top portion of the pole to allow you to attach the top balloon with a Topper Column Cap or strong tape.
- 6) Once the top balloon is attached, remove pressure on the balloons and let them rise up to meet the balloon topper. Your column is now complete!

Foil - continued

Arch Instructions:

- 1) Air inflate 38 MagicArch™ modules.
- 2) Insert half of an extension pole into the pole receiver. Use the pole half that does not have the button mechanism. You will not need the upper halves of the poles for this application.
- 3) Turn the top of pole receptacle to tighten around the pole.
- 4) Place the bases where you intend to display your arch. Place them at approximately 8-10 feet apart. The closer the bases, the higher the arch.
- 5) Assemble the bendable arch rod by inserting each black rod into the silver connector between each rod to make one long bendable arch cord and lay it on the floor.
- 6) Thread inflated MagicArch™ balloons on each extension pole mounted to the base until the poles are full.
- 7) Thread remaining balloons on the bendable arch cord and then lift arch cord from both ends. This requires two people to lift at the same time. Keep tension on the cord from both ends and be careful not to pull apart.
- 8) Person one and two: Lift the arch cord together and slowly bend to create an arch. Again, keeping tension on the cord from the ends so as not to pull the cord apart.
- 9) Person one: Insert one end of the arch cord into the top of the extension pole and allow it to slide all the way down. Hold base securely until the arch cord is inserted.
- 10) Person two: Slowly bend the arch cord more and insert the other end into the top of the other extension pole and base and allow it to slide all the way down inside the pole.

Note: This product was created for indoor use. Balloons will be damaged if exposed to water or rain.



Arch & Column Kit Instructions

Latex - #721132

Latex Arch and Column Kit includes:

- 4 Fillable Bases
- 4 Interlocking extension poles (8 pieces)
- 1 - 20 ft. expandable arch frame
- 1 High Speed electric latex balloon inflator
- 60 Balloon Rings
- 1 Set Balloon Column Topper Caps

Additional items needed:

- 160 - 11" latex balloons

Balloon Ring Instructions:

- 1) Inflate latex balloons using balloon air inflator. For best results, inflate each balloon to a consistent 10" diameter.
- 2) Insert inflated balloons into a slot in the balloon ring with the knot of the balloon on the inside of the ring. You will need four balloons for each ring.
- 3) If you are building a column, you will need eight balloon rings (32 balloons). For an arch, you will need 32 balloon rings, (128 balloons).

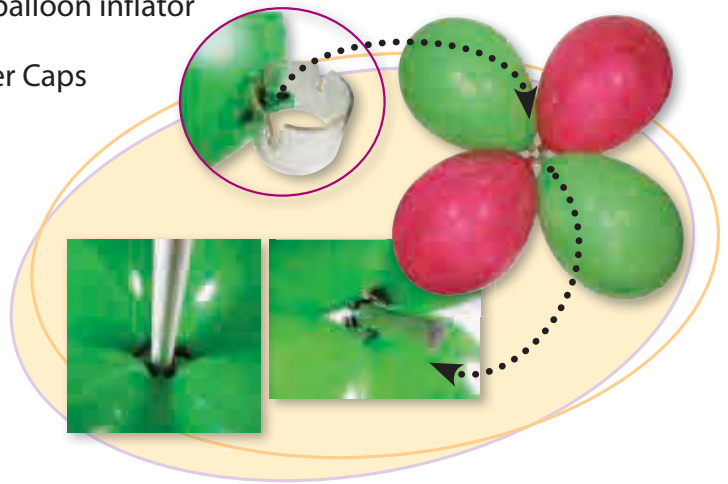

Column Instructions:

- 1) Connect both pole pieces to make 2 large extension poles. Make sure the button on one pole aligns with the hole of the other pole half and locks into place.
- 2) Insert the 62" pole into the pole receptacle cup in the base and turn the top of the pole receptacle to tighten around the pole for a secure fit. Do not over tighten.
- 3) One by one, slide a balloon ring with the 4 attached balloons over the pole. Make sure the slots on the balloon ring are facing downward. This keeps the balloons from possibly coming out of the slot.
- 4) Once the balloons are stacked on the pole, press down on the top balloons to expose enough of the top portion of the pole to allow you to attach the top balloon with a Column Topper Cap or strong tape.
- 5) Once the top balloon is attached, remove pressure on the balloons and let them rise up to meet the Column Topper Cap. Your column is now complete!

Latex - continued

Arch Instructions:

- 1) Insert half of an extension pole into the pole receiver. Use the pole half that does not have the button mechanism. You will not need the upper halves of the poles for this application.
- 2) Turn the top of pole receptacle to tighten around the pole.
- 3) Place the bases where you intend to display your arch. Place them approximately 8-10 feet apart. The closer the bases, the higher the arch.
- 4) Assemble the bendable arch rod by inserting each black rod into the silver connector between each rod to make one long bendable arch cord and lay it on the floor.
- 5) Thread the balloon rings with the 4 attached balloons on each extension pole that is mounted to the base until the poles are full (usually 3 or 4 rings). Make sure the slots on the balloon rings are facing downward and that the balloons are snugged into one another.
- 6) Thread remaining balloon rings on the bendable arch cord and then lift arch cord from both ends. This requires two people to lift at the same time. While lifting and moving the arch cord, keep tension on the cord from both ends and be careful not to pull the cord apart.
- 7) Person one and two: Lift the arch cord together and slowly bend to create an arch. Again, keeping tension on the cord from the ends.
- 8) Person one: Insert one end of the arch cord into the top of the extension pole and allow it to slide all the way down. Hold base securely until the arch cord is inserted into the other base.
- 9) Person two: Slowly bend the arch cord more and insert the other end into the top of the other extension pole and base and allow it to slide all the way down inside the pole.

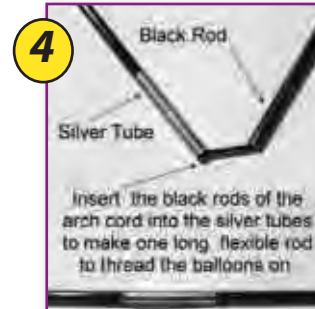



800-239-2000

Monday - Friday except holidays
5:00 am - 5:00 pm USA Pacific Time

Corporate Office & Distribution Center

16474 Greeno Road
Fairhope AL 36532-5528

Showroom & Distribution Center

5733 East Shields Avenue
Fresno CA 93727-7822



Tropical Palm Tree

#90111

Air inflate and tie together with uninflated 260.

#11246

Air inflate to create 13 four-balloon clusters. Beginning at base:

- 2 clusters - sized to 10"
- 2 clusters - sized to 9 1/2"
- 2 clusters - sized to 9"
- 2 clusters - sized to 8 1/2"
- 2 clusters - sized to 8"
- 3 clusters - sized to 7 1/2"

Work your way up the pole, adding clusters from largest balloons at the base to smallest balloons at top as shown in picture. Make sure to turn each cluster slightly so the balloons are packed tightly together.

MATERIALS

QTY	ITEM	SIZE	DESCRIPTION
9	90111	36"	Green Palm Frond Foil Shape
1	11246	11"	Chocolate Brown Latex (52 needed)
1	18304	260	Green Latex
1	720380		ProSizer Templates
1	1574		SDS Steel Base Plate
1	-		Conduit Pole (1/2" inside diameter)



Tropical Plants
on back side

©2016 Balloons Everywhere, Inc.
All rights reserved.



Tropical Plants

#18281
#18181

Air inflate at various lengths and tie the necks together. Wrap knotted necks around four-balloon clusters to secure.

#11230
#11122

Air inflate to 8" and make a four-balloon cluster. Tie lime green and dark green clusters together with an uninflated 260.

Air inflate to 10" and make a four-balloon cluster.

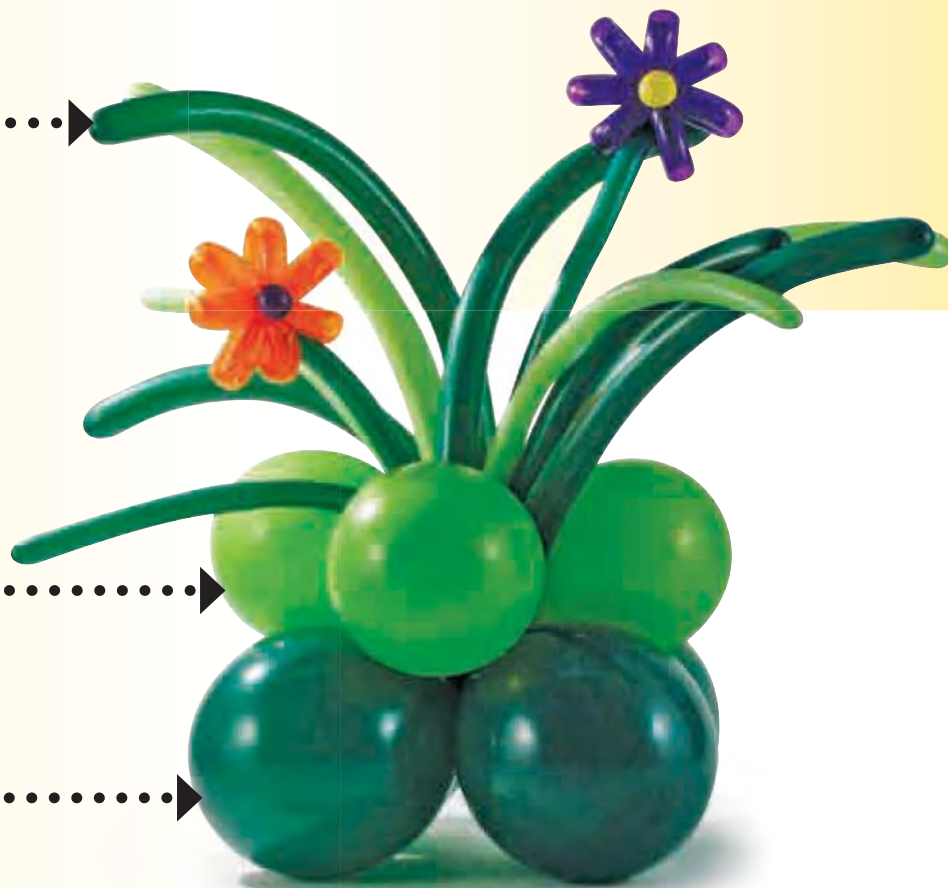

MATERIALS

QTY	ITEM	SIZE	DESCRIPTION
1	11122	11"	Dark Green Latex (4 needed)
1	11230	11"	Lime Green Latex (4 needed)
1	18281	260	Carnival Twistee Assortment (5 Green, 2 Lime Green needed)
1	18181	160	Carnival Twistee Assortment (3 Green, 2 Lime Green, 1 Purple Violet, 1 Orange needed)
1	5256	5"	Jewel Latex Assortment (1 Purple Violet, 1 Citrine Yellow needed)

©2016 Balloons Everywhere, Inc.
All rights reserved.

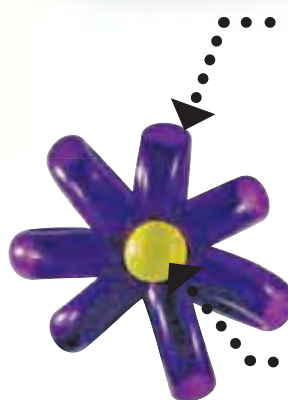

#18181

Flower Petals: Fully air inflate 160 and release a small amount of air so it is more pliable. Tie both ends together forming a complete circle. Fold to make a Z shape with knotted end at the top. Grab the Z in the middle and twist together. Arrange into a flower shape.

#5256

Flower Center: Under inflate one 5" latex balloon to 2" and tie off. Twist in the center to create two bubbles. Slide into the flower by centering each bubble on either side of the flower.



Goal Post

1. Purchase two aluminum rods (1/4" diameter x 4' long) and a 4 1/2' conduit pole (1/2" inside diameter) from your local hardware store.
2. Place the conduit pole on the base plate.
3. Bend the aluminum rods to make the goal posts as shown in diagram.
4. Place bent rods at top of conduit pole and secure with duct tape to form the goal post.
5. Air inflate two 5" balloons and tie them together to make a duplet. Make another duplet and twist the two duplets together to make a cluster of four balloons. Make a total of 40 clusters.
6. Tie a fifth balloon into two of the four balloon clusters. These will top the arms of the goal post to cover the ends of the aluminum rods.
7. Start to build your goal post by attaching your clusters to the bottom of the conduit pole and working your way up. Slip the first cluster onto the pole at the bottom. Twist two balloons together to attach it to the pole.
8. Continue adding the balloon clusters and slightly turn each cluster so the balloons pack tightly together.
9. Continue adding the clusters on to the aluminum rod until you reach the top of the goal post. To cover your mechanics, twist the five balloon clusters to the top of the goal post.
10. Attach a helium filled football foil balloon with fishing line to the top of the conduit pole.

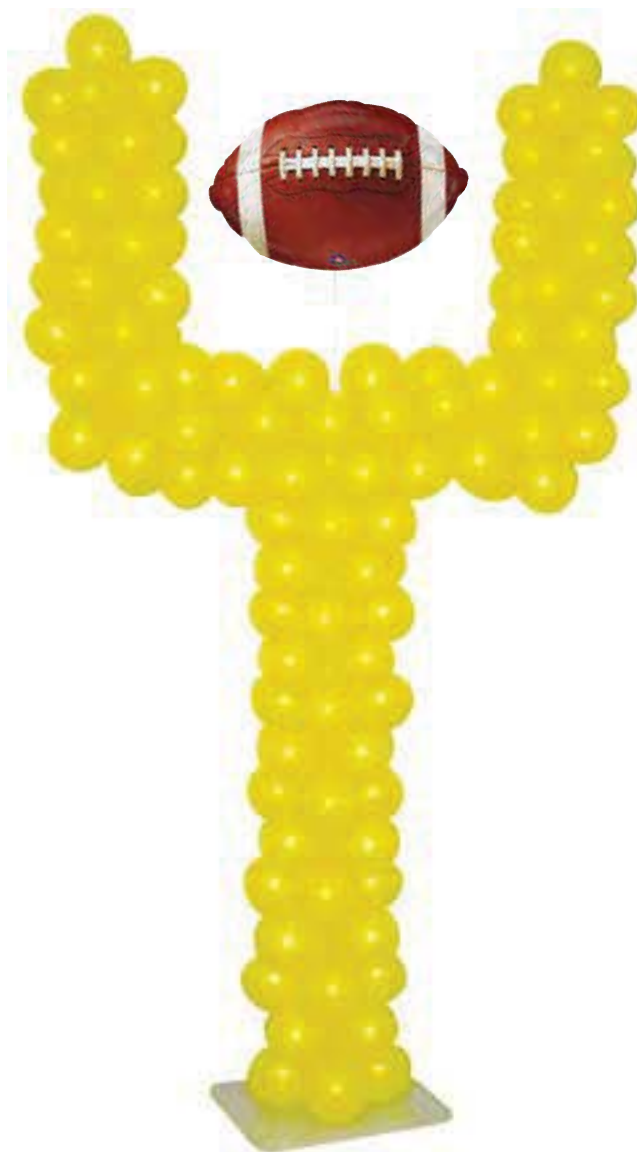

©2016 Balloons Everywhere, Inc.
All rights reserved.

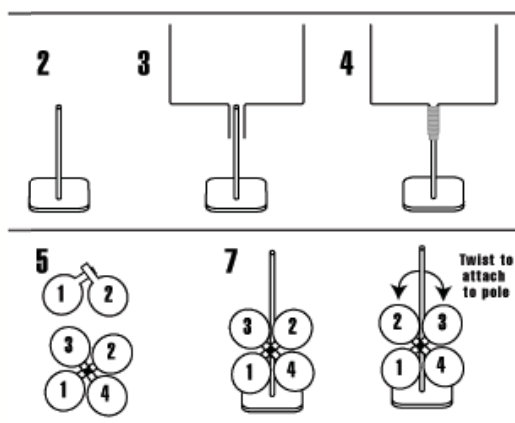

MATERIALS

QTY	ITEM	SIZE	DESCRIPTION
1	85216	21"	Football Foil Shape
2	5408	5"	Yellow Latex (162 needed)
1	1574		SDS Steel Base Plate
1	3708		Monofilament Line
2		1/4"x4'	Aluminum Rods
1		4 1/2'	Conduit Pole (1/2" diameter)



Design Guide

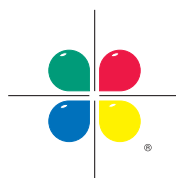

BALLOONS
EVERYWHERE

balloons.com • 800-239-2000



Quick Link™ Tower

#40121 •••••▶

Air inflate and attach to uninflated 160.
Once column is complete, tie each end of the uninflated 160 into opposite corners of the top square.

#12804 •••••▶

Air inflate to 10" and tie four together forming a balloon square. Repeat to make four squares.

#5241 •••••▶

Air inflate to 3" and make a three-balloon cluster.

#12803 •••••▶

Air inflate to 10" and tie three together forming a balloon chain of 3. Repeat to make four chains of three. Tie one end of each chain to each corner of three. Tie one end of each chain to each corner of the dark blue square.

MATERIALS

QTY	ITEM	SIZE	DESCRIPTION
1	40121	3'	Dark Blue Latex
1	12804	12"	Dark Blue Quick Link™ Balloons (16 needed)
1	12803	12"	Yellow Quick Link™ Balloons (12 needed)
1	5241	5"	Black Latex (48 needed)
1	18160	160	Traditional Assortment (2 needed)
1	1598		Heavy Smile Weights

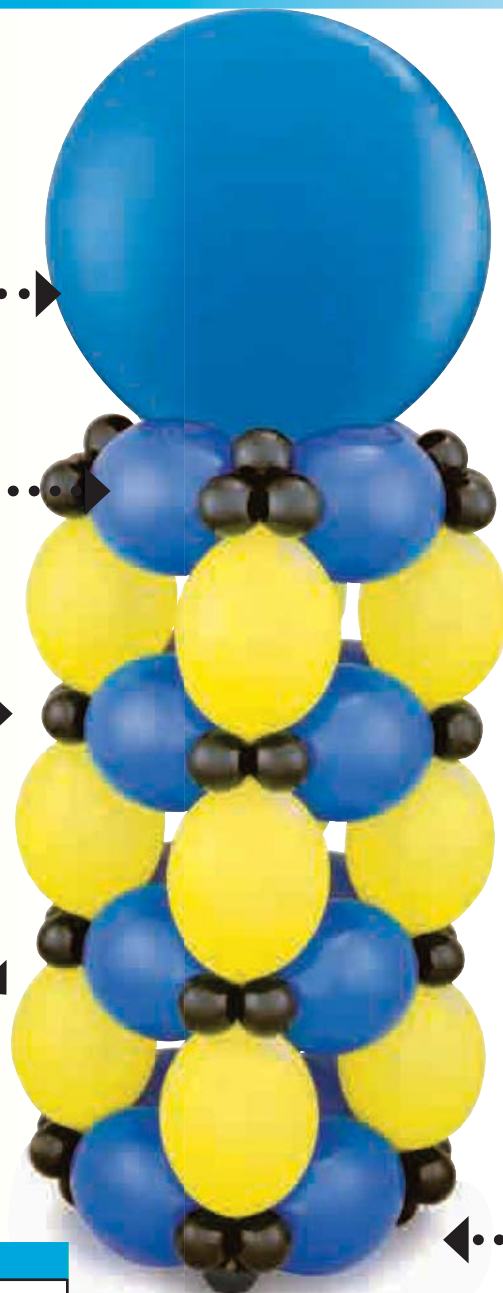

◀••••• #18160

Using an uninflated 160, tie a heavy weight onto one corner of the square.

©2016 Balloons Everywhere, Inc.
All rights reserved.
Balloons Everywhere, Inc. is a registered trademark of Balloons Everywhere, Inc.

Chain Arch

1. Air inflate four 11" purple violet latex to 10" and make a four-balloon cluster. Using an uninflated 260, tie a heavy weight to the cluster.
2. Make a four-balloon cluster with 11" wild berry latex inflated to 8". Using an uninflated 260, tie this onto the previous cluster, rotating it so it nests.
3. Make two four-balloon clusters each with two 11" orange, one 11" robin's egg blue, and one 11" lime green latex inflated to 6". Using an uninflated 260, tie one onto the 8" cluster from Step 2, rotating it so it nests. Set the second cluster aside.
4. Air inflate a yellow 646, leaving 2" uninflated, and tie. Tie the knot end into the weighted clusters. Tie off the uninflated tip of the 646 and clip the tip to let out any excess air.
5. Tie the remaining 6" cluster from Step 3 onto the uninflated end of the 646.
6. Make a purple violet curly 260, leaving 1" uninflated, and tie. Wrap the knot end into the bottom cluster on one side of the arch, and wrap the uninflated end into the cluster on top of the 646.
7. Repeat steps 1-6 for other side of the arch.
8. Helium inflate two yellow Quick Links™ to 11" and tie into a duplet. Repeat making a Quick Link™ chain of six. Tie one end of this chain into the 6" cluster on top of the 646.
9. Make a four-balloon cluster with 5" purple violet inflated to 4". Wrap this cluster between the 6" cluster and the Quick Link™ chain on top of the 646.
10. Make 2 four-balloon clusters each of wild berry, lime green and robin's egg blue sized to 4". Wrap each of these between the Quick Links™ as shown.

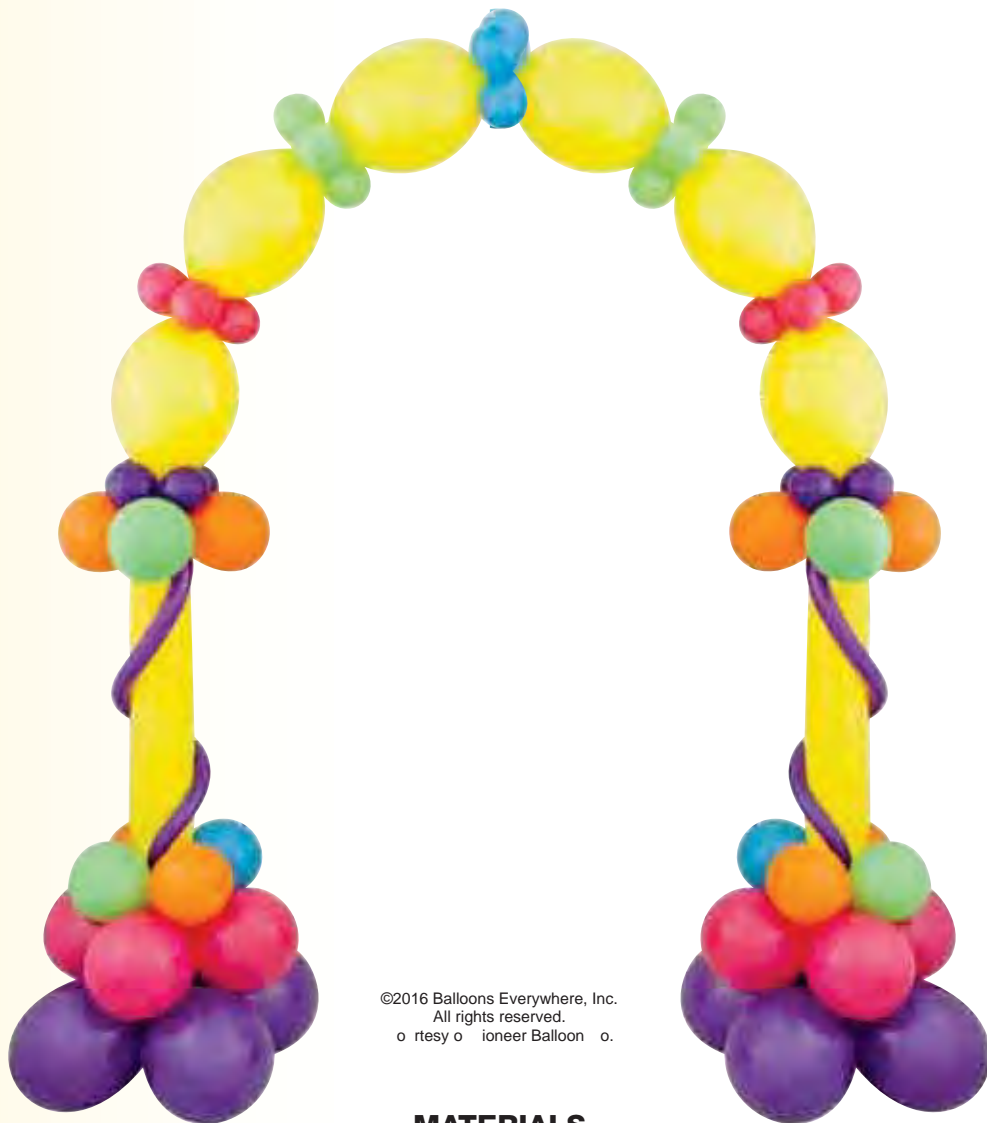

©2016 Balloons Everywhere, Inc.
All rights reserved.
o rtesy o iioneer Balloon o.

MATERIALS

QTY	ITEM	SIZE	DESCRIPTION
1	12803	12"	Yellow Quick Link™ Balloons (6 needed)
1	720511	11"	Tropical Latex Assortment (8 Purple Violet, 8 Wild Berry, 8 Orange, 4 Lime Green, 4 Robin's Egg Blue needed)
1	5240	5"	Purple Violet Latex (8 needed)
1	5230	5"	Lime Green Latex (8 needed)
1	5231	5"	Robin's Egg Blue Latex (4 needed)
1	5259	5"	Wild Berry Latex (8 needed)
1	18103	646	Special Twistee Assortment (2 Yellow needed)
1	18281	260	Carnival Twistee Assortment (6 needed)
2	1598		Heavy Smile Weights

Criss-Cross Arch

Ultra Hi-Float®, helium inflate two like-colored pairs to 11" and tie into duplets. Tie duplets together to form a chain of 16, in order shown. Repeat to form an identical chain.

Air inflate two like-colored pairs to 3.5" and tie into duplets. Set aside.

#12803

#12806

#12810

#12804

#5124

#5230

#5122

#5121

#1598

Tie a heavy weight onto one corner of the square.

MATERIALS

QTY	ITEM	SIZE	DESCRIPTION
1	12804	12"	Dark Blue Quick Link™ Balloons
1	12810	12"	Green Quick Link™ Balloons
1	12806	12"	Lime Quick Link™ Balloons
1	12803	12"	Yellow Quick Link™ Balloons
1	5121	5"	Dark Blue Latex
1	5122	5"	Green Latex
1	5230	5"	Lime Green Latex
1	5124	5"	Yellow Latex
1	1714		Ultra Hi-Float™ (16 oz.)
2	1598		Heavy Smile Weights

Place the two chains side-by-side. Starting at the weighted end, cross one of the dark blue Quick Link™ duplets over the adjacent dark blue Quick Link™ duplet (forming an "X" shape). Wrap a 3.5" dark blue duplet around the intersecting knots, positioning one on the front and one on the back. Twist the 3.5" duplet to secure into place.

Repeat to make an "X" shape with the remaining like-colored duplets of Quick Links™ and wrap 3.5" duplets around each center as shown to secure.

©2016 Balloons Everywhere, Inc.
All rights reserved.
Courtesy of Pioneer Balloon Co.

Wall Grid

1. Air inflate two 12" caribbean blue Quick Links™ to 9" and tie into a duplet. Repeat to make three more duplets. Tie the duplets together end-to-end to make a chain of eight Quick Links™. Repeat to make seven more caribbean blue Quick Link™ chains. These will be the horizontal rows of the wall. Set aside.
2. Air inflate one caribbean blue and one white Quick Link to 9" and tie into a duplet. Repeat to make two more identical duplets. Tie the duplets together end-to-end (the colors should alternate). Inflate a single caribbean blue and tie it onto the last white to make a chain of seven Quick Links™. Repeat this process to make six more Quick Link™ chains. These will be the vertical rows of the wall. Set aside.
3. Air inflate two 5" onyx black latex to 3" and tie into a duplet. Repeat to make 71 more duplets. Set aside.
4. Take one chain from Step 1 and lay it on the ground. This will be the top (horizontal) row of the wall. Take a chain from Step 2 and tie the tip of a caribbean blue Quick Link™ onto the knot between the first two Quick Links™ in the horizontal row.
5. Tie the remaining chains from Step 2 onto the remaining knots of the top row, so that all of the vertical rows are now attached.
6. Wrap a 3" duplet from Step 3 onto the knots in the top row to hide your mechanics.
7. Attach the next horizontal row (from Step 1) to the vertical rows by wrapping a 3" duplet around each of the intersecting knots. Make sure to twist the 3" latex balloons completely around each other to lock them in place, positioning one on the front and one on the back of the wall.
8. Repeat Step 7 to attach five more horizontal rows with 3" duplets.
9. Attach the final horizontal row by tying the Quick Link™ tips from the vertical rows onto the knots. Wrap a 3" duplet onto these knots to hide your mechanics.
10. Tie a 3" duplet onto each of the Quick Link™ tips on the sides of the wall.
11. Attach each piece of conduit to a base plate.
12. Secure the sides of the wall to the conduit by wrapping the 3" latex balloons around the conduit.

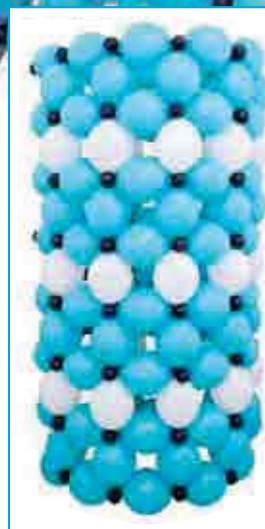
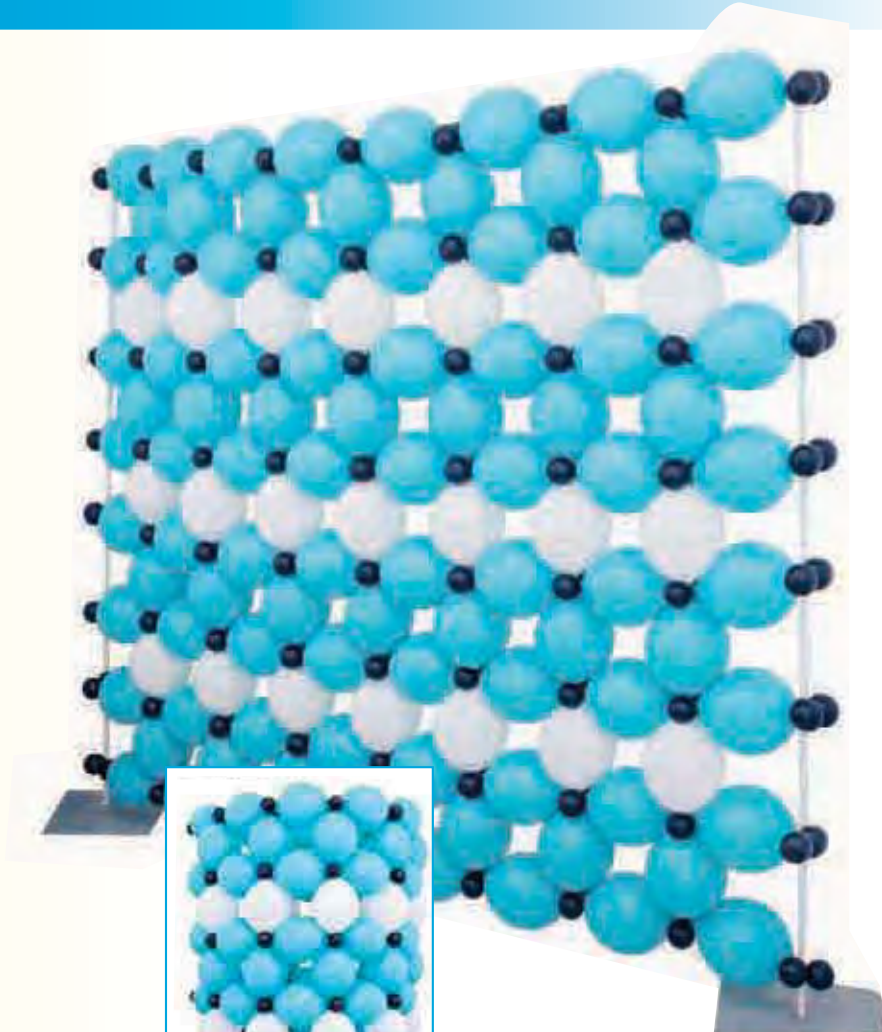

©2016 Balloons Everywhere, Inc.
All rights reserved.
Courtesy of Pioneer Balloon Co.

Variation: Move the conduit and base plates to create a curved wall or a round "pillar" effect as shown (left).

MATERIALS

QTY	ITEM	SIZE	DESCRIPTION
1	12815	12"	Caribbean Blue Quick Link™ Balloons
1	12801	12"	White Quick Link™ Balloons
1	5241	5"	Onyx Black Latex
2		9'	½" Diameter Conduit
2	1574		SDS™ Steel Base Plates

Heart Column

1. Attach a length of 4' conduit to the base plate. Pull an uninflated 11" white latex over the top of the conduit.
2. Air inflate four 11" white latex to 8" and wrap them onto the bottom of the conduit.
3. Air inflate four 5" wild berry latex to 4" and wrap them onto the conduit above the previous cluster, rotating the balloons so they nest.
4. Repeat Steps 2-3 to add three more layers of 8" white and three more layers of 4" wild berry, alternating the colors as shown.
5. Helium inflate two white Quick Links™ to 11" and tie into a duplet. Repeat to make five more duplets, tying the duplets together end-to-end to make a chain of 12. Tie the first and the last Quick Links™ together to make a circle.
6. Air inflate two 5" wild berry latex to 4" and tie them into a duplet. To connect the Quick Link™ circle to the column, pull the 4" duplet up through the top cluster on the column and wrap the duplet around one of the Quick Link™ knots. Make sure to twist the balloons around each other to lock them in place.
7. Air inflate four 5" wild berry latex to 3.5" and make a four-balloon cluster. Repeat to create five more clusters. Starting at the bottom of the Quick Link™ circle, wrap three clusters onto each side between the Quick Links™.
8. Air inflate three 5" wild berry latex sized to 3.5" and make a three-balloon cluster. Repeat to create four more clusters. Wrap these clusters onto the remaining knots of the Quick Links™.
9. To make the center point of the heart, position the three-balloon cluster beneath the two Quick Links™ as shown. Position the remaining 3-balloon clusters above the Quick Links™ as shown to form the lobes.
10. If needed, tie a length of monofilament from the center point of the heart into the column to help create a more defined shape.



©2016 Balloons Everywhere, Inc.
All rights reserved.
Courtesy of Pioneer Balloon Co.

MATERIALS

QTY	ITEM	SIZE	DESCRIPTION
1	12801	12"	White Quick Link™ Balloons
1	11128	11"	White Latex
1	5259	5"	Wild Berry Latex
1	3708		Monofilament Line
1		3'	½" Diameter Conduit
1	1574		SDS™ Steel Base Plate

Heart Wall

1. Air inflate two 5" wild berry latex to 4" and tie into a duplet. Repeat to make 19 more duplet. Set aside.
2. Air inflate the following Quick Links™ to 10" to make the components of the heart:
 - One loop of 14 Quick Links (see A in illustration)
 - One chain of five Quick Links (see B)
 - One chain of three Quick Links (see C)
 - Two chains of four Quick Links each (see D1 and D2)
 - Two chains of four Quick Links each (see E1 and E2)
 - Two chains of six Quick Links each (see F1 and F2)
3. Position the loop (A) on the ground and the two horizontal chains (B and C) below it. Starting on the left side, place the vertical chain of four (D1) on top of the loop so that the knots intersect. There should be two Quick Links™ above the loop and one Quick Link™ below the loop. Secure the Quick Links™ by wrapping a 4" duplet from Step 1 around the two intersections. Position one 4" latex on the front and one on the back. Make sure to twist the 4" balloons completely around each other to lock them in place.
4. Add the next vertical chain of four (E1) in the same manner, connecting it to the loop and also the horizontal chain of five (B).
5. Add the next vertical chain of six (F1) in the same manner, connecting it to the loop and the two horizontal chains (B and C).
6. Repeat Steps 3-5 to add the remaining Quick Link™ chains (D2, E2, and F2) to the right side of the heart.
7. Tie all of the adjacent Quick Link™ tips together on the outer edge to form the border of the heart. (The Quick Links™ at the top of D1/F1 and D2/F2 will curve inward to form the lobes.) Carefully trim the excess necks and tails of the knots.
8. Wrap the two remaining 4" duplets from Step 1 onto the knots at the top of each lobe.
9. Inflate two 5" wild berry latex to 4" tie into a duplet. Inflate a third wild berry latex to 4" and tie it into the duplet. Wrap this cluster onto the bottom point of the heart.
10. Suspend with monofilament line.



©2016 Balloons Everywhere, Inc.
All rights reserved.
Courtesy of Pioneer Balloon Co.

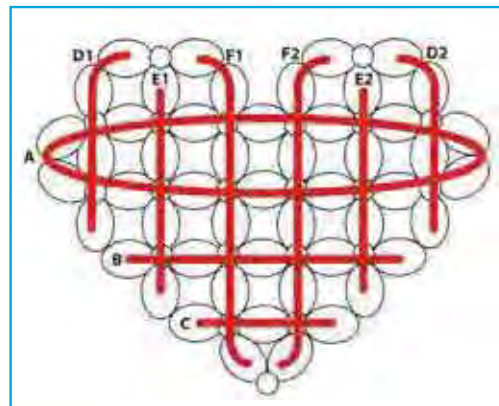

MATERIALS

QTY	ITEM	SIZE	DESCRIPTION
1	12811	12"	Wild Berry Quick Link™ Balloons
1	5259	5"	Wild Berry Latex
1	3708		Monofilament Line

Loop Arch

1. Assemble the AeroPole System according to the product instructions, using four of the included AeroPoles.
2. Air inflate two 11" wintergreen latex to 9" and tie into a duplet. Repeat to make three more duplets.
3. Starting at the bottom of one side of the arch, wrap one wintergreen duplet from Step 2 onto the frame so the two balloons are side-by-side. Wrap the other duplet onto the frame, adjacent to the first, so these two balloons are also side-by-side. Push down on the centers of each duplet to lock them together. (See Figure A.) Repeat for the other side of the arch.
4. Make 62 duplets of 5" yellow latex inflated to 4.5". Set aside.
5. Make 30 duplets using one 5" orange latex inflated to 4.5" and one 11" wintergreen latex inflated to 6.5". Set aside.
6. Make 30 duplets using one 5" orange latex inflated to 4.5" and one caribbean blue Quick Link™ inflated to 9". Set aside.
7. Air inflate four 5" yellow latex to 3" and make a four-balloon cluster. Repeat to make 29 more clusters. Attach one of these clusters onto a caribbean blue Quick Link™ from Step 6 by tightly wrapping the tip around the center several times. Repeat to add a 3" yellow cluster to the remaining Quick Links™.
8. Starting on one side of the arch, wrap two 4.5" yellow duplets from Step 4 above the wintergreen cluster, rotating the balloons so they nest. (See Figure B.) There should be two yellow balloons in front and two in back.
9. Wrap a duplet of orange and wintergreen (from Step 5) and a duplet of orange and caribbean blue (from Step 6) above the yellow cluster. (See Figure C.) Position the balloons so the wintergreen is on the inside and the caribbean blue is on the outside of the arch. The orange balloons should be positioned in the front and the back.
10. Repeat Steps 8-9 until the arch is complete. Take care not to pack the clusters so tight that the balloons are "squished". The caribbean blue balloons should just be touching each other.
11. Inflate 28 orange 260s to 29" and tie each separately. Tie off the uninflated end, and trim the excess, leaving a 1" tail.
12. Starting at the bottom left side of the arch, wrap the knot end of a 260 into the 3" yellow cluster on the Quick Link™. Skip the next Quick Link™, and wrap the other end of the 260 into the cluster on the third Quick Link™.
13. Wrap the knot end of a 260 into the 3" cluster on the second Quick Link™. Skip the next Quick Link™, and wrap the other end of the 260 into the cluster on the fourth Quick Link™.
14. Repeat Steps 12-13 to continue adding the remaining 260 loops to the arch. Take care to maintain a consistent overlapping pattern when wrapping them in.

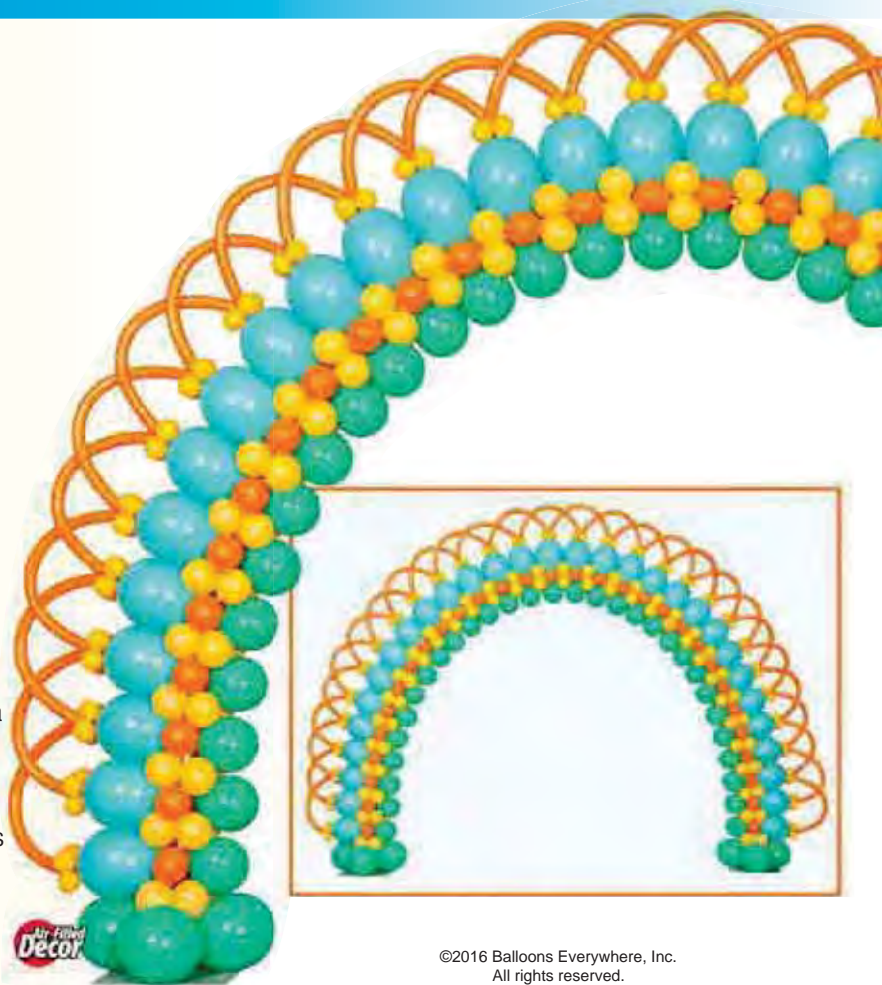

©2016 Balloons Everywhere, Inc.
All rights reserved.
o rtesy o i oneer Balloon o.



Figure A

Figure B

Figure C

MATERIALS

QTY	ITEM	SIZE	DESCRIPTION
1	12815	12"	Caribbean Blue Quick Link™ Balloons (30 needed)
1	11232	11"	Wintergreen Latex (38 needed)
3	5124	5"	Yellow Latex (244 needed)
1	5125	5"	Orange Latex (60 needed)
1	18305	260	Orange Twistee Latex (28 needed)
1	1635		AeroPole System™ Kit

Spiked Topiary

1. Air inflate two 12" white Quick Links™ to 10" and tie the necks together. Repeat to make three more duplets.
2. Twist two duplets from Step 1 together, making sure the balloons intersect at the knots so the center stays constant. Repeat to add two more duplets, one at a time, separating the previous balloons to keep the center constant.
3. Repeat Step 1 to create the last two Quick Link™ duplets, tying the balloons together as close to the neck roll as possible, and add into the previous duplets, keeping the center constant.
4. Air inflate an 11" white latex balloon to 6" and tie it onto the tip of one of the Quick Links™. Repeat to inflate 11 more latex balloons, and tie them onto the tips of the remaining Quick Links™.
5. Air inflate two 5" pearl sapphire blue latex and two 5" pastel azure latex to 4" and make a four-balloon cluster. Repeat to create 11 more clusters.
6. Wrap the clusters from Step 5 between the Quick Links™ and 6" latex as shown.
7. Tie monofilament line into the middle of the Topiary, and hang from the ceiling.



©2016 Balloons Everywhere, Inc.
All rights reserved.
Courtesy of Pioneer Balloon Co.

MATERIALS

QTY	ITEM	SIZE	DESCRIPTION
1	12801	12"	White Quick Link™ Balloons (12 needed)
1	11128	11"	White Latex (12 needed)
1	5551	5"	Pearl Sapphire Blue Latex (24 needed)
1	5218	5"	Pearl Azure Latex
1	3708		Monofilament Line

Super Sphere

1. Air inflate 10 white Quick Links™ to 10" and tie them together to make a chain. Tie the first and the last Quick Links™ together to form a circle (see Figure A). Set aside.
2. Make a chain of five white Quick Links™ inflated to 10". Tie the first and the last Quick Links™ together to form a circle (see Figure B). Repeat to make a second circle of five. Set aside.
3. Air inflate a single white Quick Link™ to 10" and tie. Inflate a 5" onyx black latex to 3" and tie it onto the neck of the Quick Link™. Inflate another 3" onyx black latex and tie it onto the tip of the Quick Link™ (see Figure C). Repeat this step to inflate nine more white Quick Links™ with a 3" onyx black latex tied to each end.
4. While holding one of the circles of five, take a Quick Link™ from Step 3 and wrap a 3" latex onto the knot between two of the Quick Links™ in the circle. Repeat to wrap four more single Quick Links™ onto the rest of the knots in the circle (see Figure D).
5. Attach the circle of ten by wrapping the remaining 3" latex from the single Quick Links™ onto every other knot in the large circle (see Figure E).
6. Attach the rest of the single Quick Links™ (from Step 3) by wrapping the 3" latex around the remaining knots in the circle of ten.
7. Attach the second circle of five by wrapping the remaining 3" latex around the knots.
8. Air inflate the 3' latex balloon inside of the Quick Link™ sphere, and tie.
9. Suspend with monofilament line.



For a different effect,
omit the 3' latex.
Shown above.

©2016 Balloons Everywhere, Inc.
All rights reserved.
Courtesy of Pioneer Balloon Co.

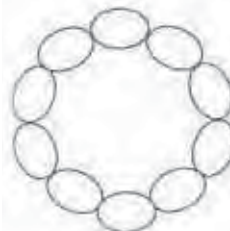

Figure A



Figure B



Figure C

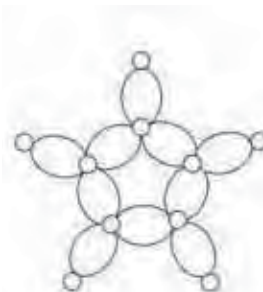

Figure D

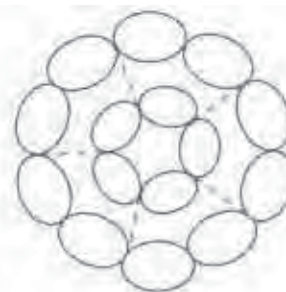

Figure E

MATERIALS

QTY	ITEM	SIZE	DESCRIPTION
1	40241	3'	Onyx Black Latex
1	12801	12"	White Quick Link™ Balloons (30 needed)
1	5241	5"	Onyx Black Latex (20 needed)
1	3708		Monofilament Line

X-Pattern Wall Grid

1. Air inflate two white Quick Links™ to 9" and tie together into a duplet. Repeat to make another duplet. Twist both duplets together to make a four-balloon cluster (see Figure A).
2. Inflate two 5" orange latex to 3.5" and tie into a duplet. Wrap this duplet into the center of the cluster from Step 1, so that one orange balloon is on the front and one is on the back.
3. Repeat Steps 1-2 to make 16 more white Quick Link™ clusters with orange centers.
4. Air inflate eight four-balloon clusters of yellow Quick Links™ sized to 9". Inflate eight duplets of 5" lime green latex sized to 3.5", and wrap each duplet into the center of a Quick Link™ cluster.
5. Using the tips of the Quick Links™, tie together five white clusters side-by-side to make the top row of the wall (see Figure B). Follow the colors and pattern shown to make the remaining four rows of Quick Link™ clusters.
6. Inflate 12 duplets of 5" white latex sized to 3.5", and four duplets of 5" yellow latex sized to 3.5". Connect all the rows from Step 5 together by wrapping a duplet around the Quick Link™ knots between each row as shown in the photo. Make sure to twist the 3.5" balloons completely around each other to lock them in place, positioning one on the front and one on the back.
7. Tie the tips of the Quick Links™ together all around the outer border of the wall. Carefully trim the excess tips.
8. Inflate 4 four-balloon clusters of 5" White latex sized to 3.5". Tie one cluster onto each corner of the wall using the Quick Link™ tip.
9. Suspend with monofilament line.

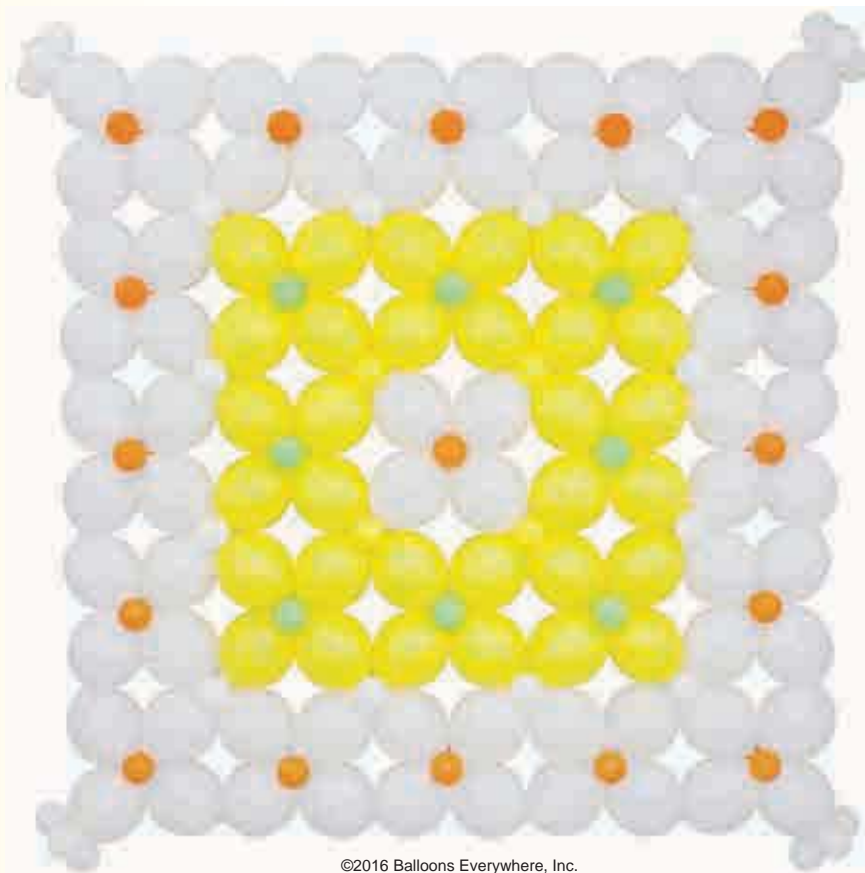

©2016 Balloons Everywhere, Inc.
All rights reserved.
Balloons Everywhere, Inc.

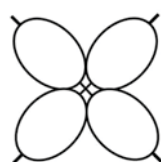

Figure A

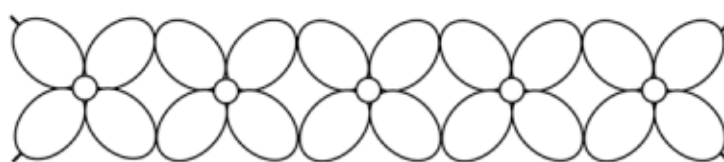

Figure B

MATERIALS

QTY	ITEM	SIZE	DESCRIPTION
1	12801	12"	White Quick Link™ Balloons (68 needed)
1	12803	12"	Yellow Quick Link™ Balloons (32 needed)
1	5128	5"	White Latex (40 needed)
1	5125	5"	Orange Latex (34 needed)
1	5124	5"	Yellow Latex (8 needed)
1	5230	5"	Lime Green Latex (16 needed)
1	3708		Monofilament Line



800-239-2000

Monday - Friday except holidays
5:00 am - 5:00 pm USA Pacific Time

Corporate Office & Distribution Center
16474 Greeno Road
Fairhope AL 36532-5528

Showroom & Distribution Center
5733 East Shields Avenue
Fresno CA 93727-7822